

ROLLER ARM BRACKET, OR A RIGHT SIDE FRAME ASSEMBLY REPLACEMENT KIT IN A NATIONAL VENDORS®, CROWN SEVENTY TWO®, SERIES OR GOLDEN FURNITURE LINE®, HBM-614 HOT BEVERAGE MERCHANDISER EQUIPPED TO USE FILTER PAPER

These instructions cover the procedure for installing a Pinch Roller Arm Assembly, Pinch Roller Arm Bracket or a Right Side Frame Assembly Replacement Kit in a Crown Seventy Two, Series or Golden Furniture Line, HBM-614 Hot Beverage Merchandiser equipped to use Filter Paper.

Read these instructions carefully and thoroughly before installing the Kit. Retain these instructions for part number and installation information.

These instructions apply to three different Kits. Kit, Part Number 613-4168, contains the following parts:

Part Number	Description	Quantity
613-4164	Pinch Roller Arm Bracket	1
610-4410	No.10-32 x 1/4 Stainless PHS Screw W/LW	1
610-4409	No.10-32 x 1/2 Stainless PHS Screw W/LW	1
610-4424	No.10-32 Stainless Nut W/LW	1
610-4220	.187 Stainless Type "E" Retaining Ring	1
613-4171	Installation Instructions * * *	1

Kit, Part Number 613-4169, contains the following parts:

Part Number	Description	Quantity
613-4166	Pinch Roller Arm	1
613-4164	Pinch Roller Arm Bracket	1
613-4135	Pinch Roller Arm Hinge Pin	1
610-4410	No.10-32 x 1/4 Stainless PHS Screw W/LW	1
610-4409	No.10-32 x 1/2 Stainless PHS Screw W/LW	1
610-4424	No.10-32 Stainless Nut W/LW	1
610-4220	.187 Stainless Type "E" Retaining Ring	1
613-4171	Installation Instructions * * *	1

Kit, Part Number 613-4170, contains the following parts:

Part Number	Description	Quantity
613-4167	Right Side Frame Assembly	1
613-4164	Pinch Roller Arm Bracket	1
610-4410	No.10-32 x 1/4 Stainless PHS Screw W/LW	2
610-4220	.187 Stainless Type "E" Retaining Ring	1
613-4171	Installation Instructions * * *	1

NOTE

If replacing the Right Side Frame Assembly, retain all parts and attaching hardware. These parts will be used during the installation of the Kit.

TO INSTALL THE KIT

A. PARTS REMOVAL

1. Unlock and open the Cabinet Door.
2. Move the Main Switch in the Merchandiser to the OFF position.
3. Remove the Brewer Mechanism Cover from the Merchandiser.
4. Remove a No.10-32 x 1/4 Stainless Pan Head Screw with Lockwasher and the Pinch Roller Arm Assembly from the Right Side Frame Assembly of the Coffee Brewer Assembly See Figure 1.
5. Remove a .187 Stainless Type "E" Retaining Ring, Pinch Roller Arm Hinge Pin and Pinch Roller Arm Bracket from the Pinch Roller Arm Assembly. See Figure 2.

NOTE

Steps 6 through 23 apply only to Kit, Part Number 613-4170.

6. Disconnect the Brew Water Funnel to Brewer Manifold Tube at the Brewer Manifold.
7. Disconnect the Air Vent Valve to Brewer Manifold Tube at the Brewer Manifold.
8. Disconnect the Brewer Funnel to Valve Assembly Tube at the Brewer Funnel.
9. Remove the Coffee Brewer Assembly from the Merchandiser. See Figure 3.
10. Remove the 1/4 x 20 Self Locking Nut, Barrel Support Spring, and Barrel Support Channel Screw attaching the Barrel Support Channel to the Right Side Frame Assembly. See Figure 3.
11. Remove the No.10-32 x 1/2 Stainless Pan Head Screw with Lockwasher and Pivot Stud attaching the Funnel Mount Lever Assembly to the Right Side Frame Assembly. See Figure 3.

Printed in U.S.A.

DGE

Copyright © 1975 by National Vendors

A Division of UMC Industries, Inc.

613-4171

R | L

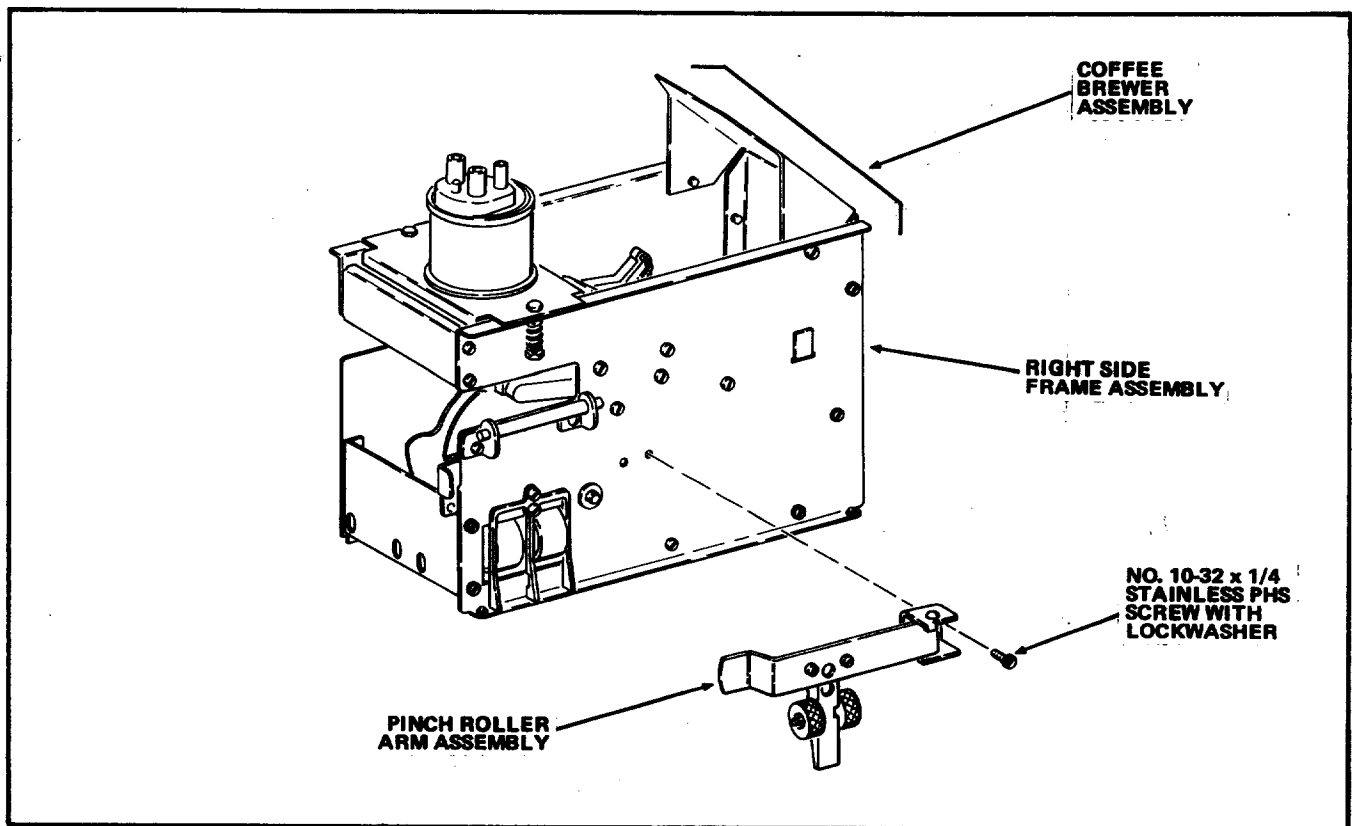

FIGURE 1

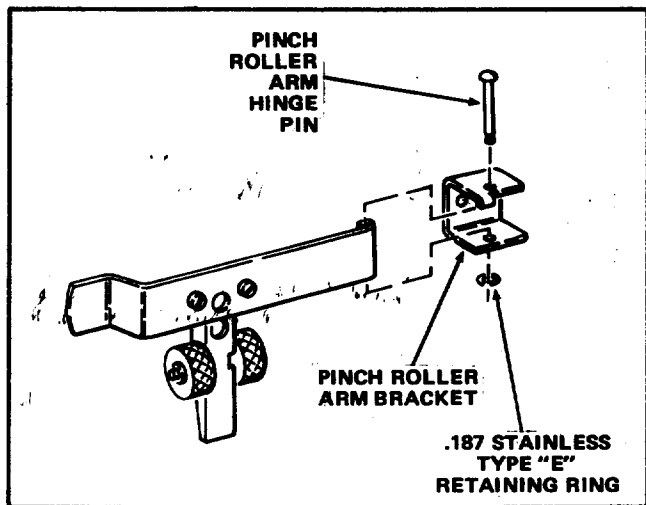

FIGURE 2

12. Remove a No.10-32 x 1/2 Stainless Pan Head Screw with Lockwasher attaching the Basket Lever Assembly to the Right Side Frame Assembly. See Figure 3.
13. Remove two No.10-32 x 1/4 Stainless Pan Head Screws with Lockwashers attaching the Front Spacer Bracket to the Right Side Frame Assembly. See Figure 3.

14. Remove two No.10-32 x 1/4 Stainless Pan Head Screws with Lockwashers attaching the Front Spacer Bracket to the Right Side Frame Assembly. See Figure 3.
15. Remove four No.10-32 x 1/4 Stainless Pan Head Screws with Lockwashers attaching the Rear Spacer Bracket to the Right Side Frame Assembly and remove the Right Side Frame Assembly from the Coffee Brewer Assembly. See Figure 3.
16. Remove two No.8-32 Stainless Nuts, four No.8-32 Stainless Lockwashers and two No.8-32 x 1/2 Stainless Hexagon Head Screws, and the Filter Paper Guide from the Right Side Frame Assembly. See Figure 4.
17. Remove a No.8-32 Stainless Nut, two No.8-32 Stainless Lockwashers, a Pinch Arm Lock Pivot, a No.8-32 x 1/2 Stainless Hexagon Head Screw, Pinch Arm Lock, Paper Guide Roller Bracket and the Guide Paper Roller from the Right Side Frame Assembly. See Figure 4.
18. Remove a No.8-32 x 3/16 Stainless Truss Head Screw and the other Paper Guide Roller Bracket from the Right Side Frame Assembly. See Figure 4.

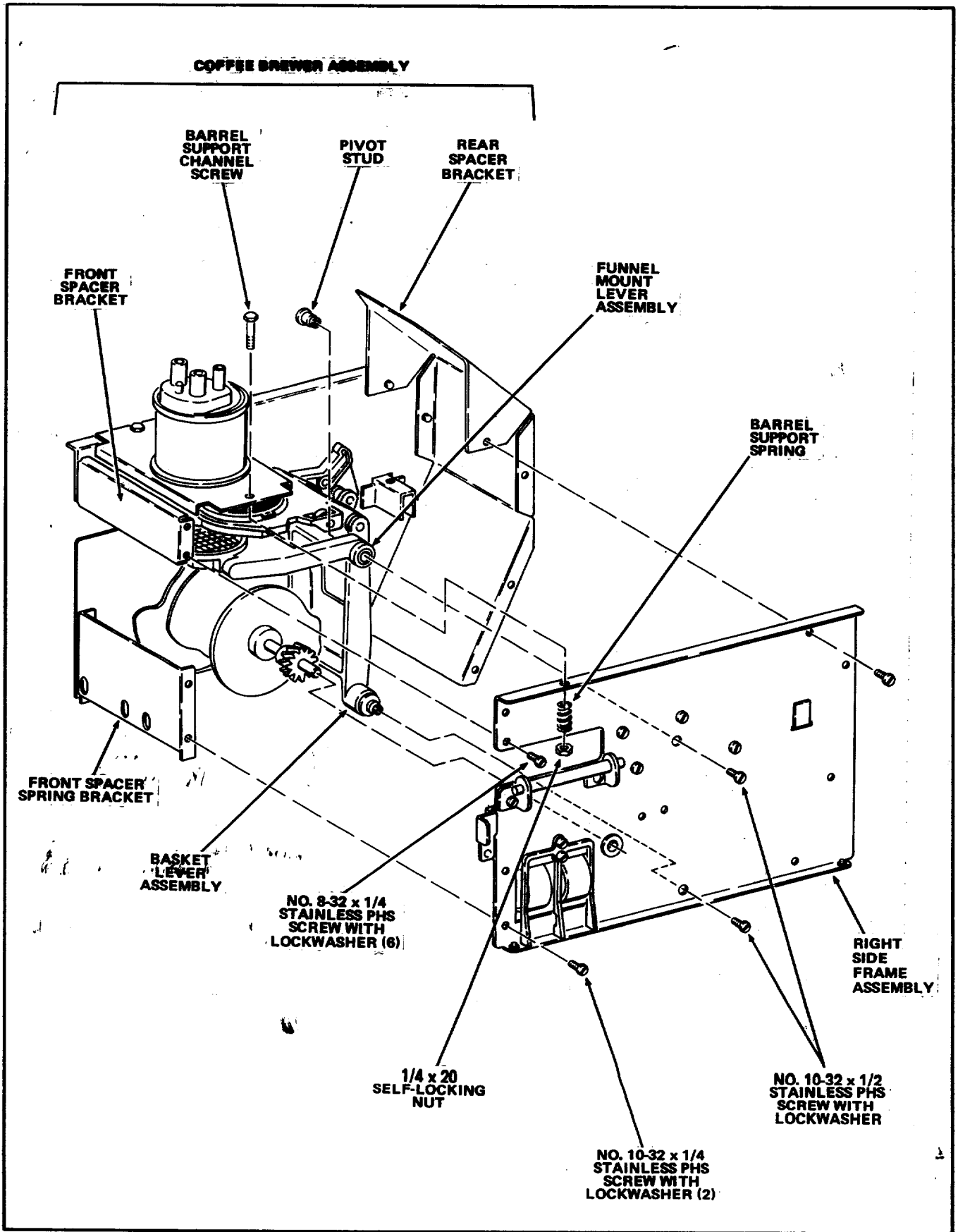

FIGURE 3

R | L

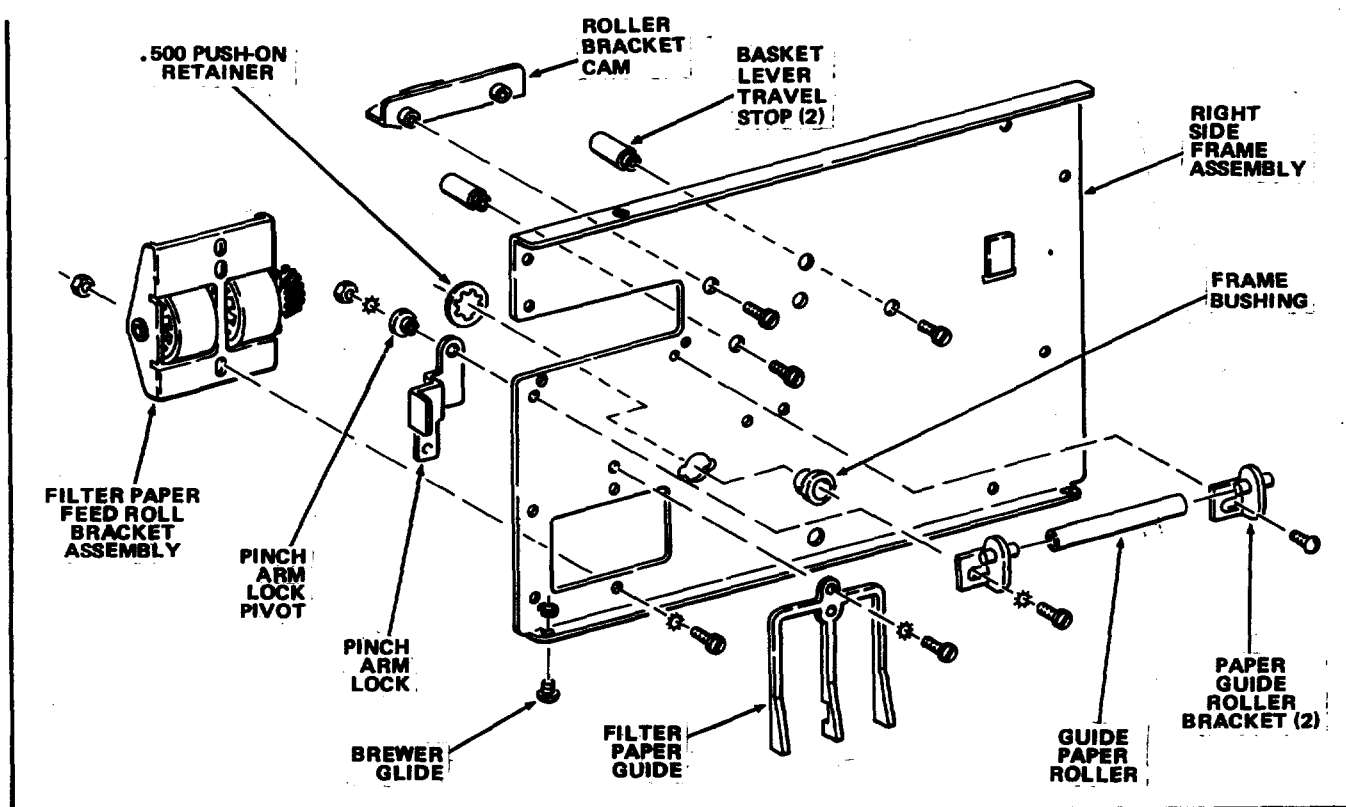

FIGURE 4

19. Remove a No.8-32 Stainless Nut, two No.8-32 Stainless Lockwasher, a No.8-32 x 3/16 Stainless Hexagon Head Screw, and the Filter Paper Feed Roll Bracket Assembly from the Right Side Frame Assembly. See Figure 4.
20. Remove two No.10-32 x 1/2 Stainless Pan Head Screws with Lockwashers and the Roller Bracket Cam from the Right Side Frame Assembly. See Figure 4.
21. Remove two No.10-32 x 1/2 Stainless Pan Head Screws with Lockwashers and two Basket Lever Travel Stops from the Right Side Frame Assembly. See Figure 4.
22. Remove the .500 Push On Retainer from the Frame Bushing and remove the Frame Bushing from the Right Side Frame Assembly. See Figure 4.
23. Remove two Retaining Rings and two Brewer Glides from the Right Side Frame Assembly. See Figure 4.

1. Attach the Pinch Roller Arm Bracket, Part Number 613-4164, included in the Kit, to the Right Side Frame Assembly of the Coffee Brewer Assembly using a No.10-32 x 1/4 Stainless Pan Head Screw with Lockwasher, Part Number 610-4410, a No.10-32 x 1/2 Stainless Pan Head Screw with Lockwasher, Part Number 610-4409, and a No.10-32 Stainless Nut with Lockwasher, Part Number 610-4424, all included in the Kit. See Figure 5.
2. Attach the Pinch Roller Arm, Part Number 613-4166, included in Kit 613-4169, to the Pinch Roller Arm Bracket with a Pinch Roller Arm Hinge Pin, Part Number 613-4135, included in Kit 613-4169, and a .187 Stainless Type "E" Retaining Ring, Part Number 610-4220, included in both Kits. See Figure 5.

NOTE

Steps 3 through 25 apply only to Kit, Part Number 613-4170.

B. INSTALLATION OF THE KIT

NOTE

Steps 1 and 2 apply only to Kits 613-4168 and 613-4169.

3. Install two Brewer Glides on the bottom edge of the replacement Right Side Frame Assembly, Part Number 613-4167, included in the Kit, and attach with two 3/16 Type "E" Retaining Rings. See Figure 6.

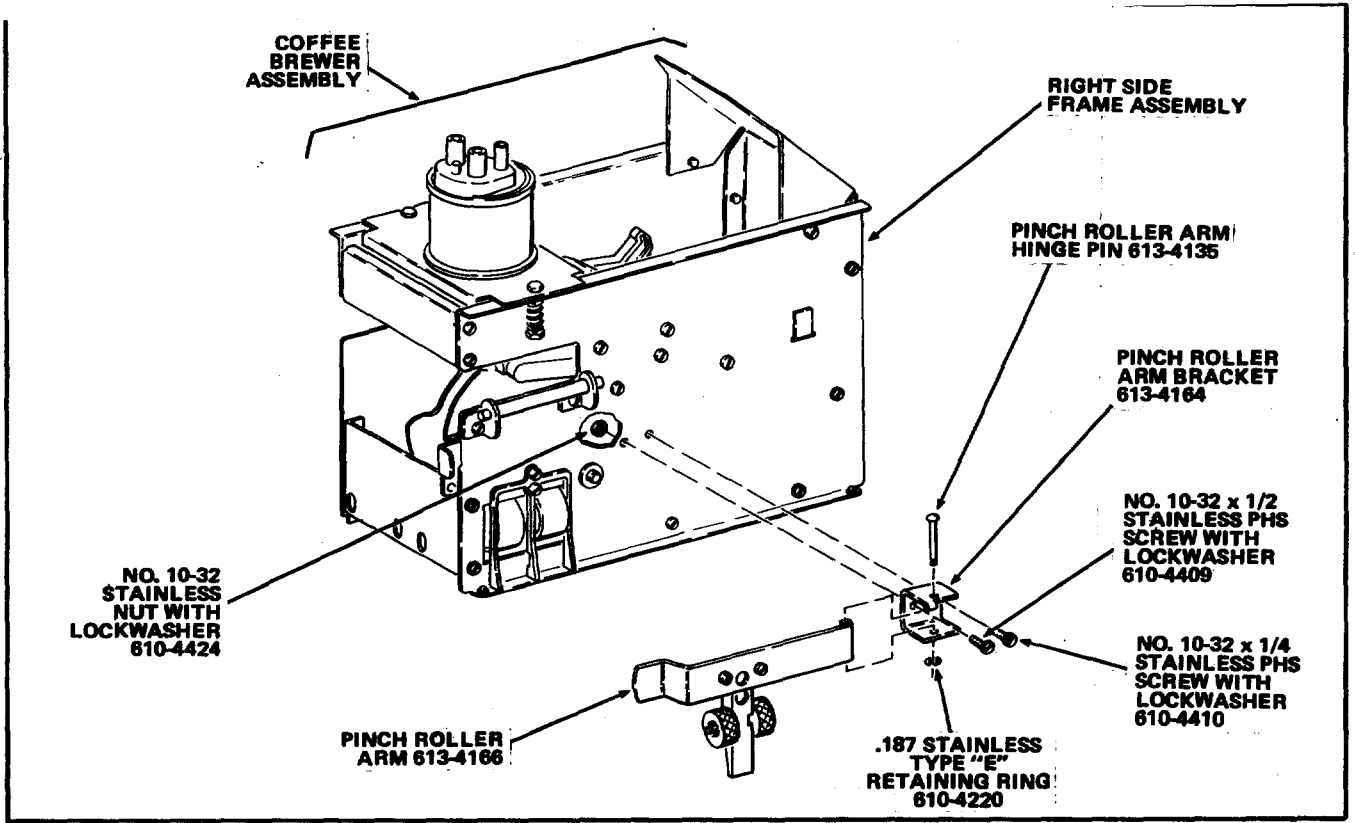

FIGURE 5

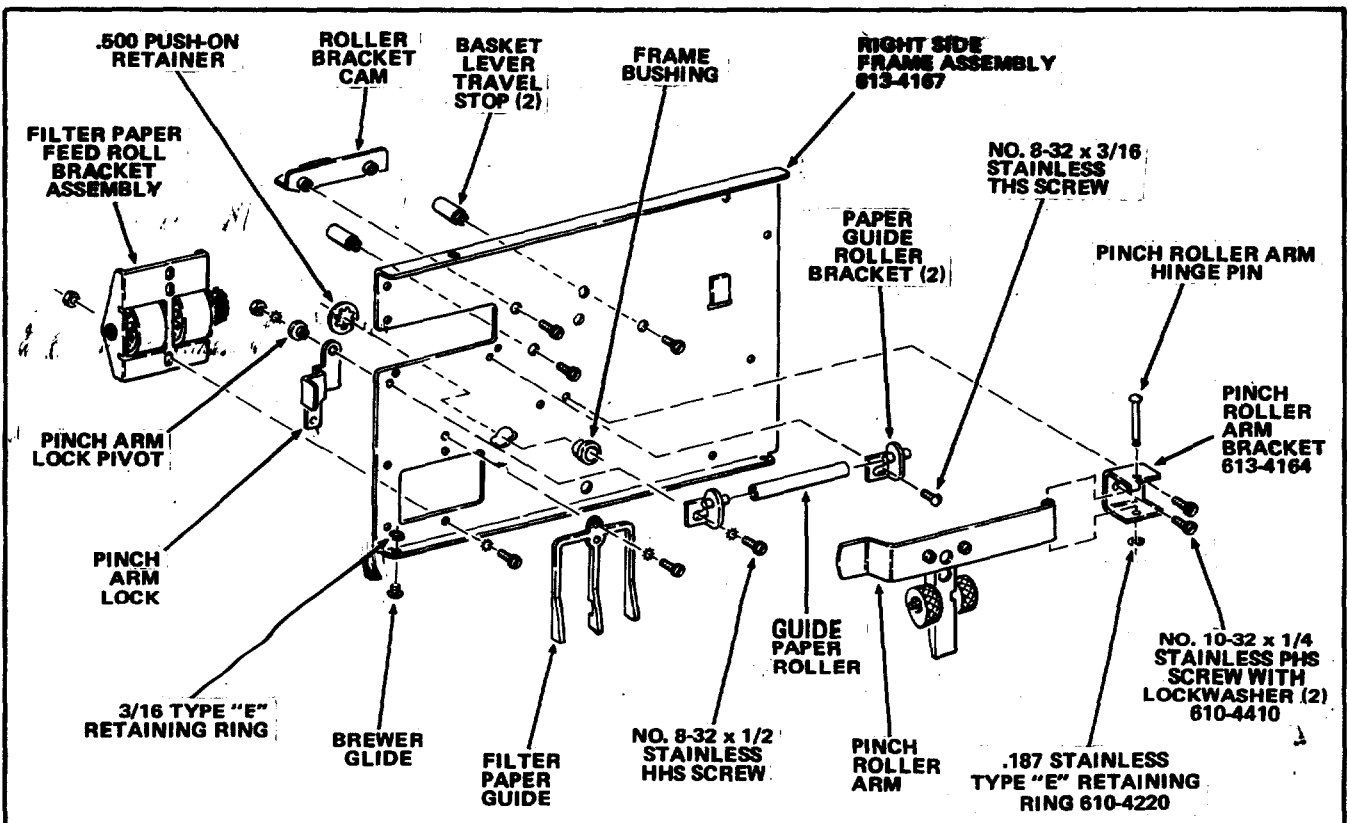

FIGURE 6

R | L

4. Install two Basket Lever Travel Stops on the inside of the Right Side Frame Assembly and attach with two No.10-32 x 1/2 Stainless Pan Head Screws with Lockwashers. See Figure 6.
5. Attach the Roller Bracket Cam to the inside of the Right Side Frame Assembly with two No.10-32 x 1/2 Stainless Pan Head Screws with Lockwashers. See Figure 6.
6. Attach the Filter Paper Feed Roll Bracket Assembly to the inside of the Right Side Frame Assembly by using a No.8-32 x 3/16 Stainless Hexagon Head Screw, two No.8-32 Stainless Lockwashers, and a No.8-32 Stainless Nut. Be sure the rollers on the Filter Paper Feed Roll Bracket Assembly can rotate freely. See Figure 6.
7. Attach the Filter Paper Guide to the outside of the Right Side Frame Assembly using two No.8-32 x 1/2 Hexagon Head Screws, four No.8-32 Stainless Nuts. See Figure 6.
8. Attach the Pinch Roller Arm Bracket, Part Number 613-4164, included in the Kit, to the Right Side Frame Assembly using two No.10-32 x 1/4 Stainless Pan Head Screws with Lockwashers, Part Number 610-4410, included in the Kit. See Figure 6.
9. Attach the Pinch Roller Arm to the Pinch Roller Arm Bracket with a Pinch Roller Arm Hinge Pin and a .187 Stainless Type "E" Retaining Ring, Part Number 610-4220, included in the Kit. See Figure 6.
10. Attach a Paper Guide Roller Bracket to the outside of the Right Side Frame Assembly with a No.8-32 x 3/16 Stainless Truss Head Screw. See Figure 6.
11. Fit the Guide Paper Roller on the Paper Guide Roller Bracket and fit the other end of the Guide Paper Roller on the other Paper Guide Roller Bracket installed in the Step B-10. See Figure 6.
12. Place the Pinch Arm Lock on the inside of the Right Side Frame Assembly and attach the Pinch Arm Lock and Paper Guide Roller Bracket to the Right Side Frame Assembly with a No.8-32 x 1/2 Stainless Hexagon Head Screw, two No.8-32 Stainless Lockwashers, a Pinch Arm Lock Pivot and a No.8-32 Stainless Nut. See Figure 6.
13. Install the Frame Bushing in the hole in the Right Side Frame Assembly and secure with a .500 Push On Retainer. See Figure 6.
14. Place the replacement Right Side Frame Assembly on the Coffee Brewer Assembly by fitting the Frame Bushing in the Right Side Frame Assembly over the Brewer Mechanism Cam Shaft. Make sure the Basket Lever Assembly is between the two Basket Lever Travel Stops. See Figure 7.
15. Fit the Pivot Stud through the hole in the Funnel Mount Lever Assembly and attach to the Right Side Frame Assembly with a No.10-32 x 1/2 Stainless Pan Head Screw with Lockwasher. See Figure 7.
16. Attach the bottom of the Basket Lever Assembly to the Right Side Frame Assembly with a No.10-32 x 1/2 Stainless Pan Head Screw with Lockwasher. See Figure 7.
17. Attach the Right Side Frame Assembly to the Front Spacer Spring Bracket with two No.10-32 x 1/4 Stainless Pan Head Screws with Lockwashers. See Figure 7.
18. Attach the Right Side Frame Assembly to the Front Spacer Bracket with two No.10-32 by 1/4 Stainless Pan Head Screws with Lockwashers. See Figure 7.
19. Attach the Right Side Frame Assembly to the Rear Spacer Bracket with four No.10-32 x 1/4 Stainless Pan Head Screws with Lockwashers. See Figure 7.
20. Attach the Right Side Frame Assembly to the Barrel Support Channel with a Barrel Support Channel Screw, Barrel Support Spring, and a 1/4 x 20 Self Locking Nut. Be sure the Barrel Support Channel Screw extends 1/16 of an inch beyond the Self Locking Nut. See Figure 7.
21. Install the Coffee Brewer Assembly into the Mounting Bracket Assembly in the Merchandiser making sure the Studs on the Coupling Arm Assembly fit in the holes in the Coupling Plate.
22. Connect the Brewer Funnel to Valve Assembly Tube to the Brewer Funnel.
23. Connect the Air Vent Valve to Brewer Manifold Tube to the Brewer Manifold.
24. Connect the Brewer Water Funnel to Brewer Manifold Tube to the Brewer Manifold.
25. Run the Filter Paper through the Coffee Brewer Assembly.
26. Install the Brewer Mechanism Cover on the Mounting Bracket Assembly in the Merchandiser.
27. Move the Main Switch in the Merchandiser to the ON position.
28. Test vend the Merchandiser.
29. Close and lock the Cabinet Door.

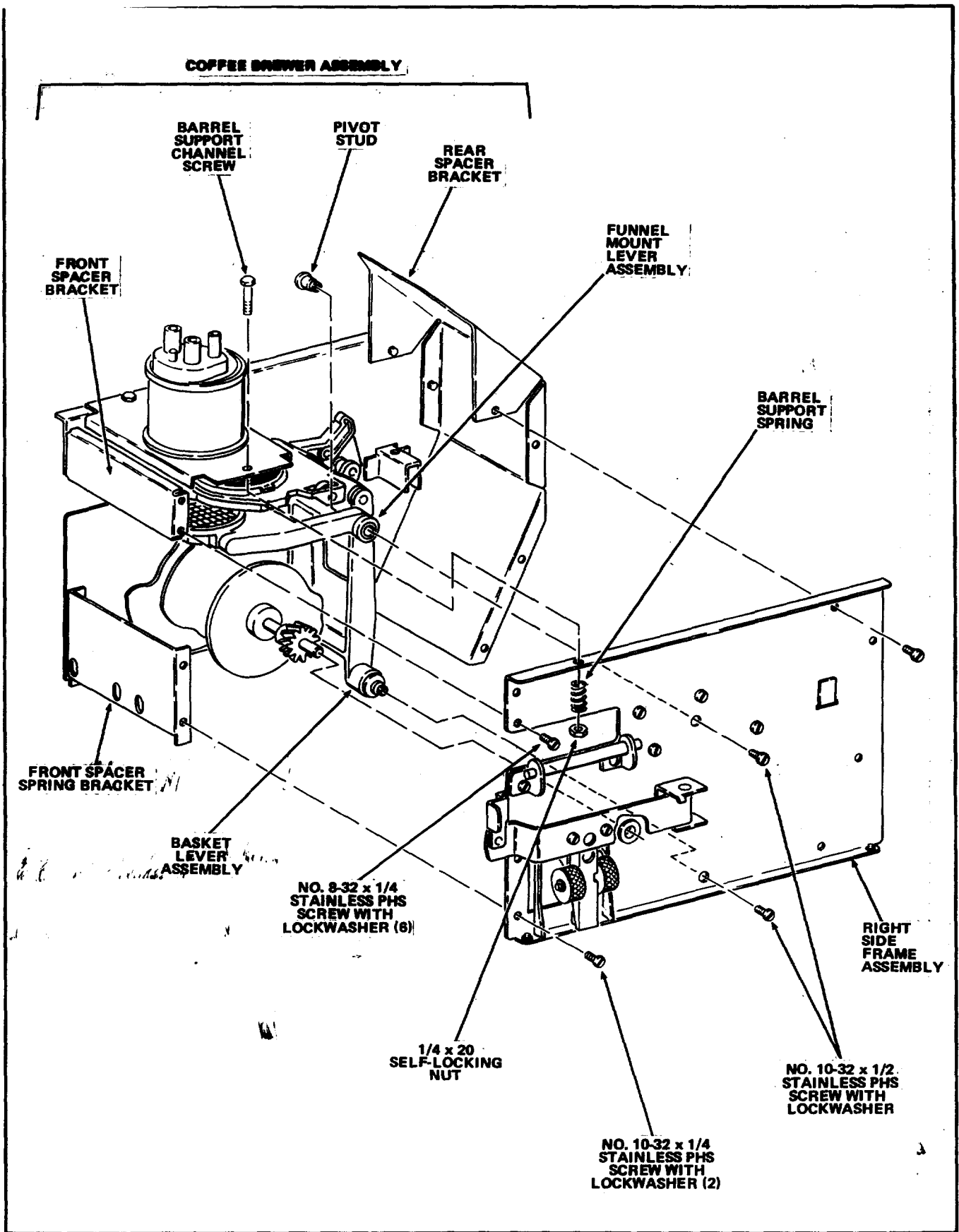

FIGURE 7

R | L